



REMOVAL AND INSTALLATION

Injector Driver Module (IDM)

Removal

1.  **WARNING: Electric shock. High voltage wires are inside the red-striped wire harness. You may receive a severe electrical shock if the wires are pierced. Do not pierce.**

 **CAUTION: Do not pierce engine electrical wires or damage to the harness can occur.**

 **CAUTION: Make sure the ignition switch is in the OFF position prior to working on the electronic engine controls.**

Turn the ignition switch to the OFF position.

2. Raise and support the vehicle; for additional information, refer to Section 100-02.
3. Remove the driver side splash guard.
 - 1 Remove the screws.
 - 2 Remove the splash guard.

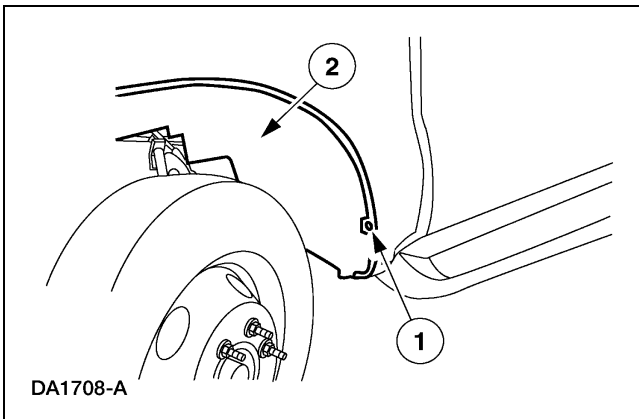

4. Remove the module.
 - 1 Loosen the connector bolt.
 - 2 Remove the wire connector.
 - 3 Remove the two retaining bolts.
 - 4 Remove the module.

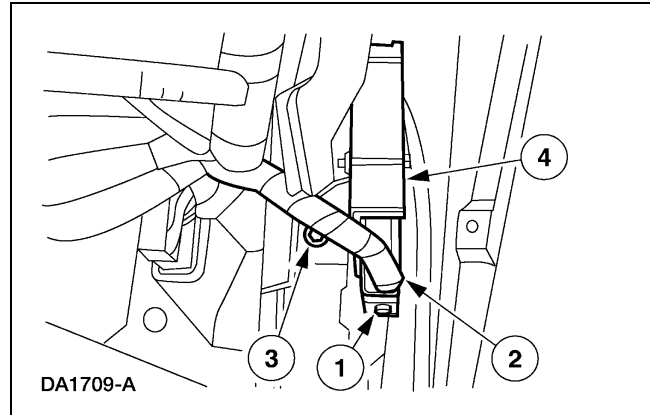

Installation

1. Follow the removal procedure in reverse order.

