

REMOVAL AND INSTALLATION

Manifold Absolute Pressure (MAP) Sensor

Removal

1.  **CAUTION: Make sure the ignition switch is in the OFF position prior to working on the electronic engine controls.**
Turn the ignition switch to the OFF position.
2. Remove the manifold absolute pressure (MAP) sensor.
 - 1 Disconnect the pressure line.
 - 2 Disconnect the electrical connector.
 - 3 Remove the two mounting screws.

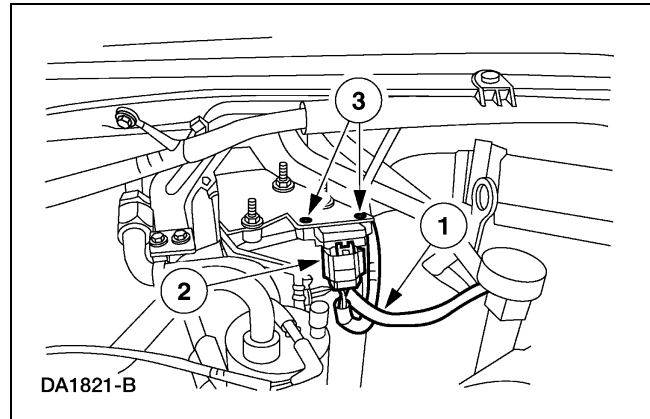

Installation

1. Follow the removal procedure in reverse order.